

SPECIFICATION / TECHNICAL SHEET

Specifications

Nominal Voltage	12V (6 cells per unit)	
Rated capacity (10 hour rate)/CCA	80Ah/540CCA	
Dimensions	Length	260±2mm
	Width	168±2mm
	Height	211±2mm
	Total Height	215±2mm
Approx. Weight	25.3kg±3%	

Characteristics

Capacity (25°C)	10HR(10.8V)	80Ah
	3HR(10.8V)	61.5Ah
	1HR(10.5V)	46Ah
Terminal type	T14	
Internal resistance (Fully charged, 25°C)	Approx. 5m Ω	
Capacity affected by temperature (10HR)	40°C	102%
	25°C	100%
	0°C	85%
	-15°C	65%
Self-discharge (25°C)	3month	Remaining Capacity:91%
	6month	Remaining Capacity:82%
	12month	Remaining Capacity:65%
Nominal operating temperature	25°C±3°C	
Operating temperature range	Discharge	-15°C-50°C
	Charge	-10°C-50°C
	Storage	-20°C-50°C
Float charging voltage(25°C)	13.50 to 13.80V Temperature compensation: -18mV/°C	
Cyclic charging voltage(25°C)	14.50 to 15.00V Temperature compensation: -30mV/°C	
Maximum charging current	24A	
Maximum discharge current	700A(5 sec.)	
Designed floating life(20°C)	10years	

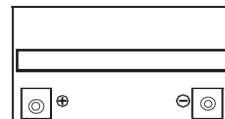
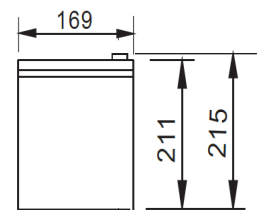
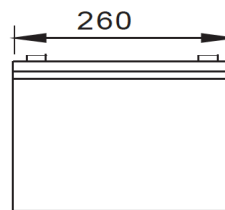
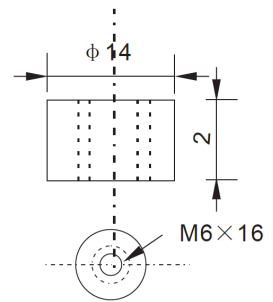

Applications

- All Purpose
- Standby Applications
- Recreation Vehicles
- Uninterruptible Power Supply (UPS)
- Electric Power System (EPS)
- Fire & Security
- Generators
- Medical Equipment

SPECIFICATION / TECHNICAL SHEET cont.

Construction

Component	Positive plate	Negative plate	Container	Cover	Separator	Electrolyte	Safety valve	Terminal
Raw material	Lead dioxide	Lead	ABS	ABS	AGM	Sulfuric acid	Rubber	Copper

Constant Current Discharge Characteristics Unit: A 25°C

F.V/Time	10min	15min	30min	60min	2h	3h	4h	5h	8h	10h	20h
9.60V	179	138	82.4	50.7	30.0	21.6	17.2	14.7	10.1	8.35	4.42
9.90V	173	134	80.8	49.9	29.8	21.5	17.1	14.6	10.1	8.33	4.42
10.2V	166	129	78.3	48.6	29.5	21.3	17.0	14.5	9.99	8.31	4.40
10.5V	159	125	76.4	47.1	29.1	21.2	16.9	14.4	9.92	8.26	4.38
10.8V	150	118	73.6	45.6	28.3	20.5	16.4	14.0	9.62	8.20	4.35

Constant Power Discharge Characteristics Unit: W 25°C

F.V/Time	10min	15min	30min	60min	2h	3h	4h	5h	8h	10h	20h
9.60V	1931	1513	925	578	347	254	203	174	120	99.7	53.1
9.90V	1873	1476	906	569	345	252	201	173	120	99.5	53.0
10.2V	1795	1422	878	555	342	251	200	172	119	99.2	52.8
10.5V	1718	1373	857	537	337	249	199	171	118	98.6	52.5
10.8V	1622	1301	826	520	328	241	193	165	114	97.9	52.2

Note: The above characteristics data can be obtained within three charge or discharge cycles.



For pricing and availability please contact the team at
PHB on 0400 864 840 or admin@phbatteries.com.au